

PROJECT	DESIGNATION
1006056	1006056
CONTRACT	BRIDGE FILE
R-	N/A

INDIANA DEPARTMENT OF TRANSPORTATION



ROAD PLANS

NORTH NINTH STREET ROAD AT BURNETT'S ROAD SIGHT CORRECTION AND PASSING BLISTER PROJECT NO. 1006056 CONST.

NORTH NINTH STREET ROAD AT BURNETT'S ROAD, LOCATED IN SECTIONS 5 & 6 OF BURNETT'S RESERVE AND IN SECTIONS 27 & 34, TOWNSHIP 24 NORTH, RANGE 4 WEST, TIPPECANOE TOWNSHIP, TIPPECANOE COUNTY, INDIANA.

BURNETT'S ROAD	
TRAFFIC DATA	
A.A.D.T. 2011	3900 V.P.D.
A.A.D.T. 2031	4800 V.P.D.
D.H.V. 2031	480 V.P.D.
DIRECTIONAL DISTRIBUTION	50%
TRUCKS	10% A.A.D.T. 11% D.H.V.
DESIGN DATA	
DESIGN SPEED	45 M.P.H.
PROJECT DESIGN CRITERIA	3R (NON-FREEWAY)
FUNCTIONAL CLASSIFICATION	LOCAL AGENCY COLLECTOR
RURAL/URBAN	URBAN (SUBURBAN)
TERRAIN	LEVEL
ACCESS CONTROL	NONE

NORTH NINTH STREET		
TRAFFIC DATA		
		SOUTH OF BURNETT'S RD.
		NORTH OF BURNETT'S RD.
A.A.D.T. 2011	5500 V.P.D.	2800 V.P.D.
A.A.D.T. 2031	6700 V.P.D.	3400 V.P.D.
D.H.V. 2031	710 V.P.D.	390 V.P.D.
DIRECTIONAL DISTRIBUTION	51%	53%
TRUCKS	9% A.A.D.T. 15% A.A.D.T.	5% A.A.D.T. 4% A.A.D.T.
DESIGN DATA		
DESIGN SPEED	45 M.P.H.	
PROJECT DESIGN CRITERIA	3R (NON-FREEWAY)	
FUNCTIONAL CLASSIFICATION	LOCAL AGENCY COLLECTOR	
RURAL/URBAN	URBAN (SUBURBAN)	
TERRAIN	LEVEL	
ACCESS CONTROL	NONE	

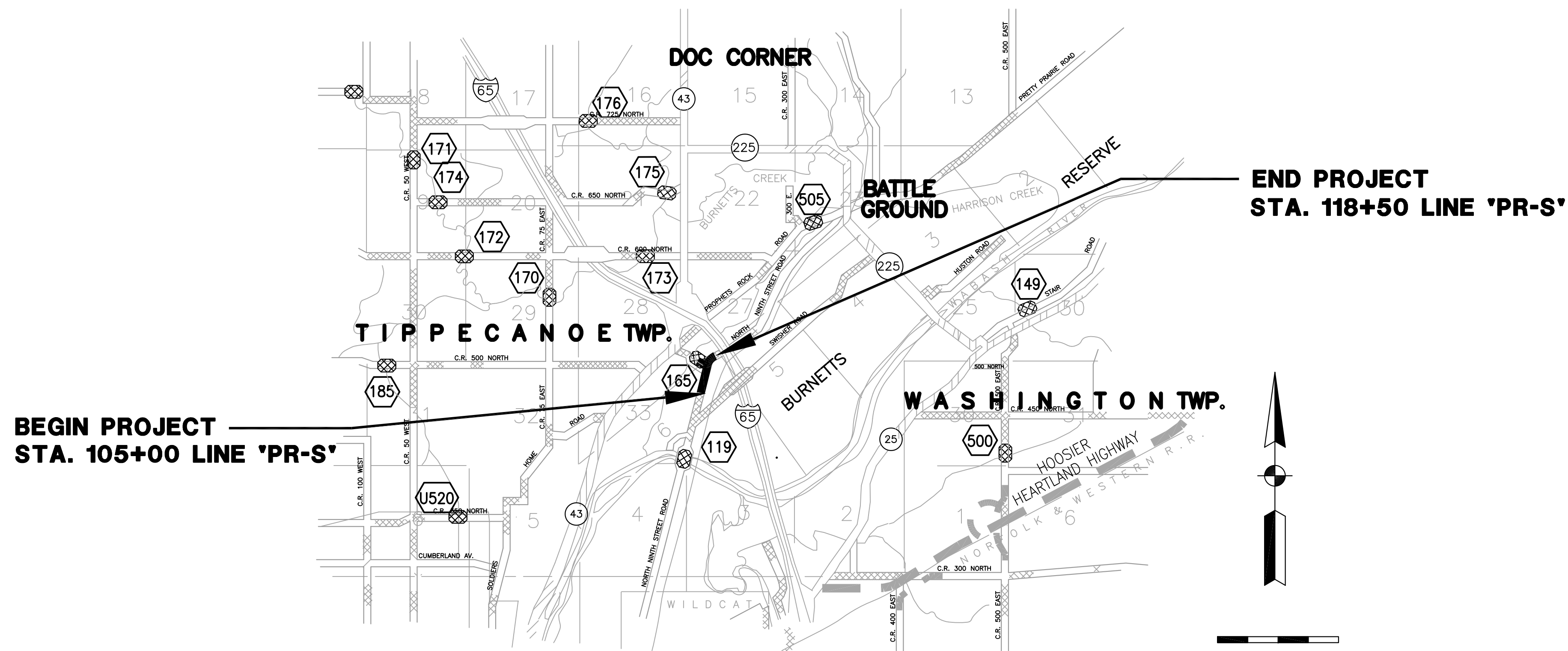
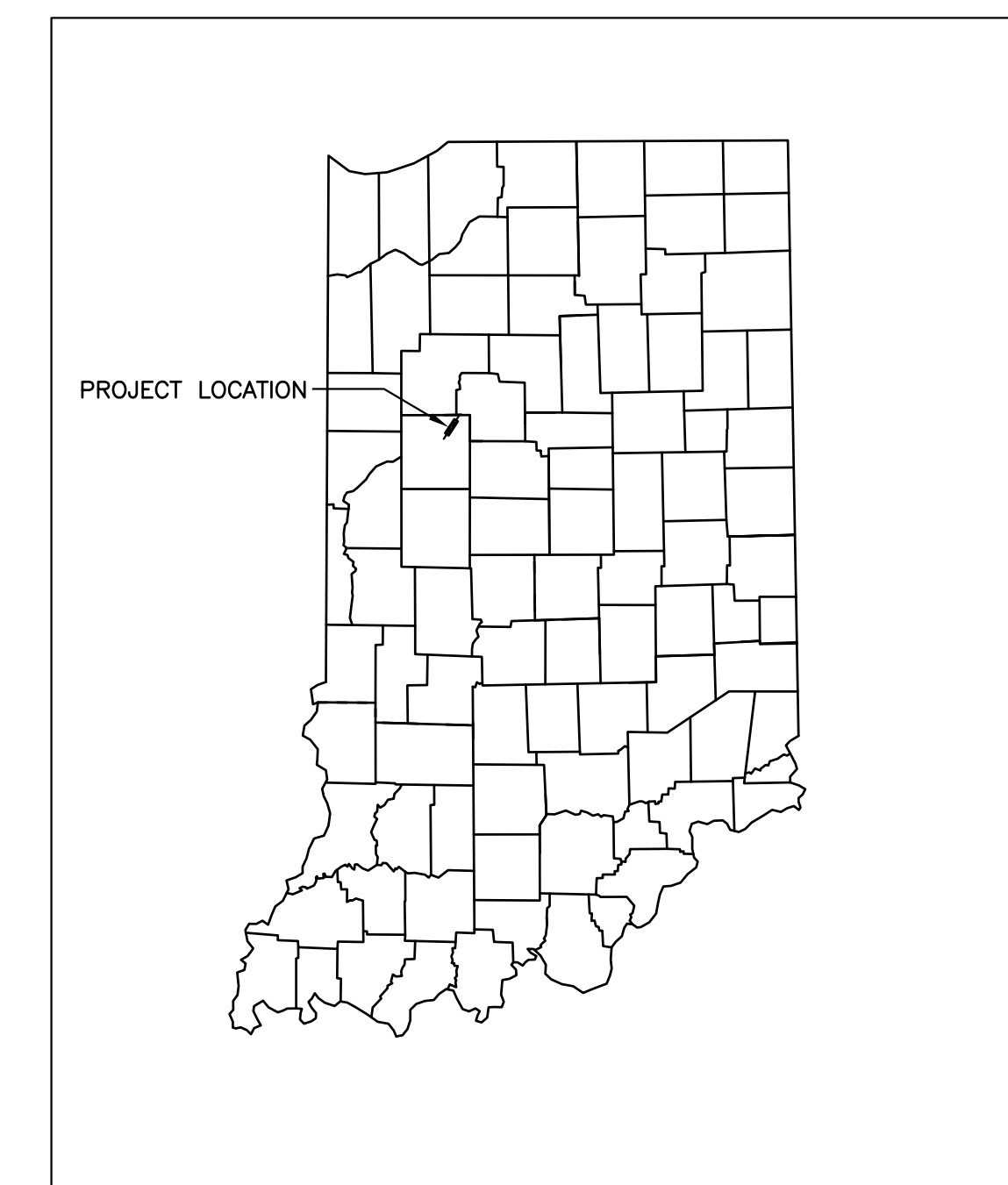

**BEGIN PROJECT
STA. 105+00 LINE 'PR-S'**

**END PROJECT
STA. 118+50 LINE 'PR-S'**

LOCATION MAP

RECOMMENDED FOR APPROVAL

OPAL KUHL, P.E. EXECUTIVE DIRECTOR
TIPPECANOE COUNTY HIGHWAY DEPARTMENT

DATE

BOARD OF COUNTY COMMISSIONERS
JOHN KNOCHER, PRESIDENT
DAVID BYERS, VICE PRESIDENT
THOMAS MURTAUGH, MEMBER

AUDITOR
JENNIFER WESTON

COUNTY HIGHWAY DEPARTMENT
OPAL KUHL, P.E. EXECUTIVE DIRECTOR
MICHAEL SPENCER, ASSISTANT EXECUTIVE DIRECTOR



PLANS PREPARED BY: H. STEWART KLINE & ASSOCIATES (765) 742-0295	PHONE NUMBER
CERTIFIED BY:	DATE
APPROVED FOR LETTING:	DATE
INDIANA DEPARTMENT OF TRANSPORTATION	

HORIZONTAL SCALE AS SHOWN	BRIDGE FILE N/A
VERTICAL SCALE AS SHOWN	DESIGNATION 1006056
SURVEY BOOK VESTER 08093-SB591	SHEETS 01 of 31
CONTRACT R-	PROJECT 1006056

LATITUDE: 40°29'18.17" N
LONGITUDE: 86°51'50.15" W
HUC14: 05120108010030

GROSS LENGTH : 0.26 MILES
NET LENGTH : 0.26 MILES
MAXIMUM GRADE : 2.00%

[INDIANA DEPARTMENT OF TRANSPORTATION STANDARD SPECIFICATIONS DATED 2010 TO BE USED WITH THESE PLANS]